



PRIDE[®]

MOBILITY
LIVE YOUR BEST[®]

SCOOTER COLLECTION



3-4

Zero Turn 10 /
Zero Turn 8

5-6

Baja Wrangler® 2/
Raptor

7-8

Victory® 10 LX w/ CTS/
Pursuit® ES

9-10

Victory® 10.2 /
Victory® Twin

11-12

Maxima /
Pursuit® XL

14

Accessories

15

Specifications

“

MY PRIDE SCOOTER IS
SIMPLE TO OPERATE
AND A BREEZE TO TRANSPORT.
I TAKE MY SCOOTER EVERYWHERE
WITH ME. PRIDE SCOOTERS HAVE
GIVEN ME MY LIFE BACK!

— Sandy M.,
Kingston, ON

ZERO TURN 10

The Zero Turn 10 can traverse the most beautiful, out-of-reach places and move seamlessly through doors and hallways in your home. This scooter combines powerful dual motors and two-wheel drive with revolutionary turning technology. Let the Zero Turn 10 carry you to places unknown.



Up To
24
Miles Per Charge at 200 lbs.

43"
Turning Radius

Up To
7.2mph
Maximum Speed

400lbs.
Weight Capacity



Up To
13.1
Miles Per Charge at 200 lbs.

37.25"
Turning Radius

Up To
5.9mph
Maximum Speed

325lbs.
Weight Capacity

ZERO TURN 8

Your mobility has turned a corner with the Zero Turn 8, an innovative scooter equipped with *iTurn Technology™*, enabling you to maneuver this scooter through small spaces and around tight corners! Plus, enjoy full lighting, plenty of storage and a USB charger.

Sapphire Blue

Pewter

Pearl White

Black Onyx

Green Moonstone

Fire Opal

Candy Apple Red

Ocean Blue
(Matte)

Pearl White

Black
(Matte)

BAJA™ WRANGLER® 2

Rugged and built to last, the Baja™ Wrangler® 2 is everything you want in an outdoor scooter. Equipped with front and rear suspension, this aggressive scooter is designed for cruising on walking trails or driving around your property. Make your adventures legendary with the Baja™ Wrangler® 2!



Up To
29.3
Miles Per Charge at 200 lbs.
with 100 AH batteries

94.75"
Turning Radius

Up To
11.4mph
Maximum Speed at 200 lbs.

450lbs.
Weight Capacity

Up To
31
Miles Per Charge at 220 lbs.

60"
Turning Radius

Up To
14mph
Maximum Speed

400lbs.
Weight Capacity



RAPTOR

Do you have the need for speed? The Raptor drives at speeds up to 14 mph. Equipped with a regenerative braking system, ample storage and complete LED lighting, the Raptor appeals to the adventurer within you!

True Blue

Desert Sand

Matte Black with Optional Inserts

True Blue

Candy Apple Red

Green Machine

Lemon Crush

Pink Topaz

Evolution Orange

Matte Black

Optional Inserts

VICTORY[®] 10 LX WITH CTS SUSPENSION

You're active and always on the go. You need a scooter that is up to the task! Appeal to your sporty side with the Victory[®] 10 LX with CTS Suspension. Enjoy premium suspension, bright lighting and other sophisticated features, all in one sporty package.



Up To
16.2
Miles Per Charge at 400 lbs.

61.25"
Turning Radius

Up To
5.6mph
Maximum Speed

400lbs.
Weight Capacity

Up To
33.6
Miles Per Charge

68.5"
Turning Radius

Up To
9.5mph
Maximum Speed

350lbs.
Weight Capacity



The Pursuit[®] ES offers a rugged design that is extremely versatile. With front and rear suspension, the Pursuit navigates outdoor terrain with ease. Cruise at speeds up to 9.5 mph (with HS version) and experience a full lighting package, including turn signals and an angle-adjustable LED headlight for optimal illumination.

Candy Apple Red

Viper Blue



Candy Apple Red

Viper Blue



VICTORY® 10.2

Embrace your potential! The Victory® 10.2 is fully loaded with style and advanced features, including frosted LED headlights and an integrated storage space with cup holder. Drive at speeds up to 5.2 mph and see what life has in store for you!



Up To
13.5
Miles Per Charge
(At rated weight capacity)

42"
3-Wheel Turning Radius

52.25"
4-Wheel Turning Radius

Up To
5.2mph
Maximum Speed

400lbs.
Weight Capacity

Also available in 3-wheel. Please see back page for specs.

VICTORY® Twin

The sleek, sporty Victory® Twin delivers high performance operation, feather-touch disassembly and a full complement of advanced standard features like exclusive low-profile tires, dual front wheels for added stability and a wraparound delta tiller, the Victory® Twin is a greater value than ever before.

Up To
11.1
Miles Per Charge
(At rated weight capacity)

42"
Turning Radius

Up To
5.7mph
Maximum Speed

350lbs.
Weight Capacity



Candy Apple Red

Ocean Blue
(Matte)



Candy Apple Red

Viper Blue



MAXIMA 2021

The new Maxima is better than ever! The all-new infinite position lever makes it easier to adjust the tiller. Experience the comfort of a new high-back, depth adjustable limited recline seat that swivels for easier access. The Maxima scooter comes standard with front and side bumpers, a USB charger and full LED lighting!



Up To
19.8
Miles Per Charge

49"
3-Wheel Turning Radius

53"
4-Wheel Turning Radius

Up To
5.8mph
Maximum Speed

500lbs.
Weight Capacity

Also available in 4-wheel. Please see back page for specs.

Garnet Red
(Matte)

Ocean Blue
(Matte)



The Pursuit® XL is an exciting blend of power and precision that features a 24-volt DC motor, full suspension, 13" low-profile tires and a hydraulic-sealed brake system. Standard luxury touches, such as an infinite adjustable wrap-around delta tiller, reclining seat and LED lighting make it the perfect outdoor scooter



Up To
30
Miles Per Charge
(G27 batteries)

82.5"
Turning Radius

Up To
7.5mph
Maximum Speed

400lbs.
Weight Capacity

Candy Apple Red

Silver



ACCESSORIES

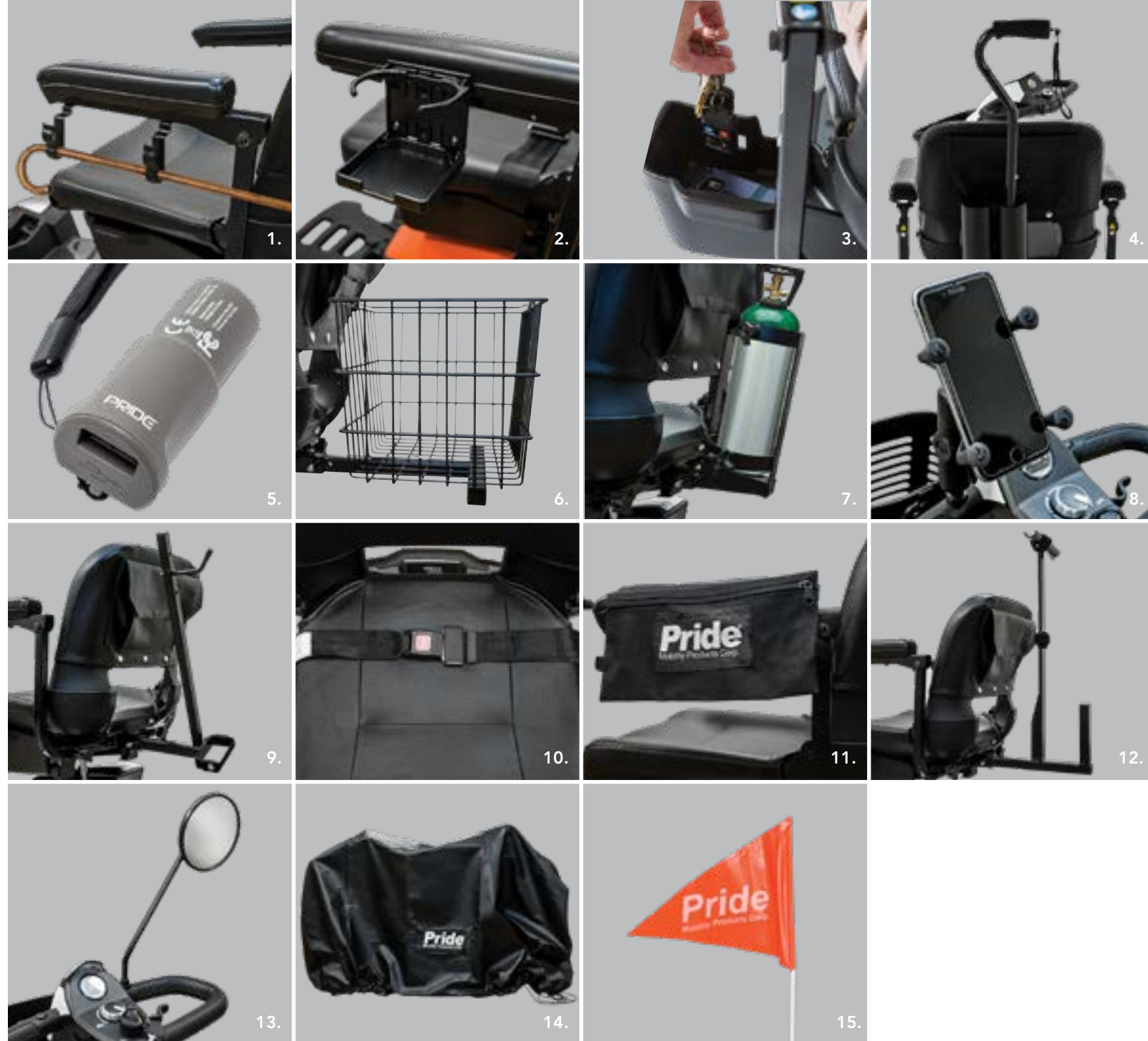

1. Cane Clip Attachment | 2. Cup Holder | 3. Under Seat Storage | 4. Single OR Double Cane Holder | 5. XLR USB CHarger
 6. Rear Basket | 7. Oxygen Holder | 8. Ram® X-Grip Cell Phone Holder | 9. Wishbone Crutch Holder | 10. Lap Belt | 11. Saddlebag
 12. Walker Holder | 13. Rearview Mirror | 14. Weather Cover | 15. Safety Flag

MODEL NAME	ZERO TURN 10 ¹⁸	ZERO TURN 8 ^{10,18}	BAJA™ WRANGLER® 2 ¹⁸	RAPTOR ¹⁸	VICTORY® 10 LX with CTS ¹⁸	PURSUIT® ES ¹⁸	VICTORY® 10.2 ¹⁰	VICTORY® TWIN ^{10,18}	MAXIMA ¹⁸	PURSUIT® XL ¹⁸
WEIGHT CAPACITY	400 lbs.	325 lbs.	450 lbs.	400 lbs.	400 lbs.	350 lbs.	400 lbs.	350 lbs.	500 lbs.	400 lbs.
MAXIMUM SPEED ²	Up to 7.2 mph	Up to 5.9 mph	Up to 11 mph at 350 lbs. Up to 11.4 mph at 200 lbs.	Up to 14 mph	Up to 5.6 mph	Up to 6 mph HS: up to 9.5 mph	Up to 5.2 mph	Up to 5.7 mph	Up to 5.8 mph	Up to 7.5 mph
GROUND CLEARANCE ^{4,13}	2" at motor 3" at mid frame	1.3" at motor	5.5" at motor	3.5" at mid-frame	2.25" at motor	2.2" at motor, 3.15" at mid-frame	2.5" at motor	2.25" at motor	3W: 2.5" at motor 4W: 2.25" at motor	2.5" at rear frame
TURNING RADIUS ⁴	43"	37.25"	94.75"	60"	61.25"	68.5"	3W: 42" 4W: 52.25"	42"	3W: 49" 4W: 53"	71"
OVERALL LENGTH / WIDTH ^{4,12}	48" / 24.25"	45.75" / 20.75"	61.25" / 32.5"	59" / 27.13"	47" / 22.25"	53.5" / 25.5"	3W: 45" 4W: 47.25" / 22.25"	46" / 22.3"	47.5" / 27"	56.25" / 27.25"
SEAT-TO-GROUND HEIGHT ⁴	23.25" - 24.75"	22" - 23.5"	29" - 30.5"	28"	23.5" - 25.5"	24.75" - 26.25"	22" - 24"	23" - 24.5"	22.1" - 24.1" 22.32" - 28.56" (w/ power elevating seat)	26.25" - 27.75"
SEAT-TO-DECK HEIGHT ⁴	17.75" - 19.25"	17" - 18.5"	18.75" - 20.25"	19"	16.5" - 18.5"	17.75" - 18.75"	15.25" - 17.25"	17.5" - 19"	17.13" - 19.13" 17.36" - 23.61" (w/ power elevating seat)	18" - 19.5"
FRONT WHEELS ⁴ (TIRES)	9" solid	2" x 7" solid	14.5" tubeless pneumatic	3" x 16" Tubeless Pneumatic	3.5" x 10" solid (pneumatic optional)	4" x 13" pneumatic	3.5" x 10" solid	Dual 3.5" x 9" solid	3W: 10.5" x 3.6" solid 4W: 10" x 3.6" solid	13" pneumatic
REAR WHEELS ⁴ (TIRES)	10.75" solid	2.5" x 9" solid	14.5" tubeless pneumatic	3" x 16" Tubeless Pneumatic	3.5" x 10" solid (pneumatic optional)	4" x 13" pneumatic	3.5" x 10" solid	3.5" x 10" solid	10.75" x 3.6" solid	13" pneumatic
SUSPENSION	Front and rear (CTS)	Front and rear (CTS)	Front and rear (CTS)	Front and rear	Front and rear (CTS)	Front and rear	N/A	N/A	N/A	Front and rear
RANGE PER CHARGE ^{2,9}	Up to 18 miles (at 400 lbs.) Up to 24 miles (at 200 lbs.)	Up to 11 miles (at 325 lbs.) Up to 13.1 miles (at 200 lbs.)	Up to 18.6 miles (75 AH @ 350 lbs.) Up to 22.6 miles (75 AH @ 200 lbs.) Up to 24.2 miles (100 AH/ travel battery @350 lbs.) Up to 29.4 miles (100 AH/ travel battery @200 lbs.)	19 miles (up to 400 lbs. and full speed) 31 miles (up to 220 lbs. and at low speed)	Up to 16.2 miles	Up to 33.6 miles HS: Up to 22 miles	3W/4W: Up to 11 miles (U-1) 3W: Up to 13 miles (40 AH) 4W: Up to 13.5 miles (40 AH)	Up to 11.1 miles (with U-1 batteries)	3W: Up to 19.8 miles 4W: Up to 19.5 miles	G31: Up to 31.83 miles G27: Up to 29.51 miles G24: Up to 22.13 miles
HEAVIEST PIECE ⁴	75 lbs. (front section)	48 lbs. (rear section)	219 lbs. (unit does not disassemble)	313.6 lbs. (unit does not disassemble, weight includes seat, base and batteries)	77.6 lbs. (front section)	118 LBS. (main frame)	3W: 56.5 lbs. (front section) 4W: 64.5 lbs. (front section)	55 lbs. (front section)	3W: 183.5 lbs. 4W: 196.75 lbs. (unit does not disassemble)	221 lbs. (main frame)
STANDARD SEATING	Type: Foldable, deluxe contour Width: 18", Depth: 17"	Type: Compact, foldable Width: 17", Depth: 17"	Type: Pillow-top, limited recline Width: 18.5", Depth: 16.5"	Type: 100° limited reclining high back with headrest Width: 20", Depth: 18"	Type: Limited reclining high-back Width: 18", Depth: 18"	Type: High back recliner with seat slide, swivel, adjustable arms and height-adjustable headrest Width: 18.5", Depth: 18.5"	Type: Foldable Width: 18", Depth: 17"	Type: Foldable Width: 18", Depth: 17"	Type: Depth-adjustable limited recline high-back Dimensions: 22" x 18"-20"	Type: High back recliner with seat slide, swivel, adjustable arms and height-adjustable headrest Width: 18", Depth: 18"
DRIVE SYSTEM	24-volt DC motor, rear-wheel drive, dual in-line	24-volt DC motor, rear-wheel drive, dual in-line	24-volt DC motor, rear-wheel drive, dual in-line	24-volt DC motor, rear-wheel drive, sealed transaxle	24-volt DC motor, rear-wheel drive, sealed transaxle	24-volt DC motor, rear-wheel drive, sealed transaxle	24-volt DC motor, rear-wheel drive, sealed transaxle	24-volt DC motor, rear-wheel drive, sealed transaxle	24-volt DC motor, rear-wheel drive, sealed transaxle	24-volt DC motor, rear-wheel drive, sealed transaxle
BRAKING SYSTEM	Regenerative and electromechanical	Regenerative and electromechanical	Regenerative and electromechanical	Regenerative and electromechanical	Regenerative and electromechanical	Regenerative and electromechanical	Regenerative and electromechanical	Regenerative and electromechanical	Regenerative and electromechanical	Regenerative and electromechanical
BATTERIES ⁷	(2) 40 AH (included)	(2) 22 AH (included)	(2) 75 AH ¹⁶ (standard) (2) 100 AH ^{15,16}	(2) 75 AH (included)	2) U-1 ¹⁶ or (2) 40AH ¹⁶	(2) GROUP 24 ¹⁶	(2) U-1 (included) (2) 40 AH ¹⁶	(2) U-1 (included) (2) 40 AH ¹⁶	(2) NF-22 (included)	(2) Group 31 (110AH) ^{15,16} (2) Group 27 (100AH) ¹⁶ (2) Group 24 (75 AH) ¹⁶
BATTERY WEIGHT ¹¹	30.25 lbs. each	Battery box 32 lbs., 13.5 lbs. each	75 AH – 48 lbs. each; 100 AH – 60 lbs. each	53 lbs. each	24 lbs. each (U-1) 32 lbs. each (40AH)	53 lbs. each	24 lbs. each (standard) 32 lbs. each (optional)	24 lbs. each (U-1) 32 lbs. each (40AH)	36.5 lbs. each	70 lbs. each (G31) 60 lbs. each (G27) 53 lbs. each (G24)
BATTERY CHARGER	Off-board, 3.5 amp	Off-board, 3.5 amp	Off-board, 8 amp	Off-board, 8 amp	Off-board, 5 amp	Off-board	Off-board, 3.5 amp (U-1) Off-board, 5 amp (40 AH)	Off-board, 3 amp (U-1) Off-board, 5 amp (40 AH)	Off-board, 5 amp	Off-board, 8 amp

PRIDE[®]

MOBILITY
LIVE YOUR BEST[®]

Beamsville, ON | 888-570-1113 | pridemobility.ca |    

1. All shroud panels included with choice of colour.
2. Varies with user weight, terrain type, battery amp- hour (AH), battery charge, battery condition and tire condition. This specification can be subject to a variance of (+ or -) 10%.
3. Battery weight not included.
4. Due to manufacturing tolerances and continual product improvement, this specification can be subject to variance of + or - 3%.
5. 12 AH battery pack weighs 18 lbs.
6. Durable solid plastic.
7. Deep cycle (AGM or gel cell type recommended).
8. 18 AH battery pack weighs 28 lbs.
9. Tested in accordance with ANSI/RESNA, WC Vol 2, Section 4 and ISO 7176-4 standards. Results derived from theoretical calculations based on battery specifications and drive system performance. Test conducted at maximum weight capacity.
10. Includes pathway illumination light.
11. Battery weight may vary based on manufacturer.
12. Width of base (not including seat).
13. Does not account for anti-tip clearance.
14. Includes standard seat weight.
15. Option available through most providers. Not available through Pride Mobility[®].
16. Optional.
17. At midframe.
18. Light package

NOTE: All specifications subject to change without notice.

The information contained herein is correct at the time of publication; we reserve the right to alter specifications without prior notice. Speed and range vary with user weight, terrain type, battery charge, battery condition and tire pressure. Due to manufacturing tolerances and continual product improvement, length, width, turning radius and ground clearance can be subject to variance of + or - 3%. Dimensions listed are for scooter only. Overall measurements will vary based on seating and accessory selections.

**Not all accessories are available for all products. Please speak with your Provider for details and availability.

