

Figure 1. Removing the Motor

Replacing the motor on a Q6 Edge 2.0 or Q6 Edge 3

Tools needed:

- Metric socket set
- Ratchet
- T-handle Allen wrench 5mm
- Phillips screwdriver
- Wire cutters
- Wire-ties
- Torque wrench (suggested)

To remove the motor:

1. Turn off the power to the controller.
2. Set the power chair up on blocks.

NOTE: If you are replacing both motors, work on one side at a time.

3. Remove the lug nuts and drive wheel from the motor.
4. Remove the drive wheel fender. If there are fender lights, place the fender on the power base or seating to keep it out of the work area.
5. Remove the rear shroud to access the power module and unplug motor/brake connection from the power module.
6. Cut and remove any wire-ties that secure the motor/brake harness. Make note of the wire-tie locations, so they can be replaced later.
7. Insert screwdriver into the motor mount support slot. (Shown in blue.)
8. Remove the four screws from the motor mount and backing plate. The screwdriver supports the motor in the bracket. Hold motor, then remove screwdriver. (Shown in red.)
9. Lower the motor from the motor mount weldment. Remove the backing plate.
10. Remove the motor/brake harness and make note of its routing.



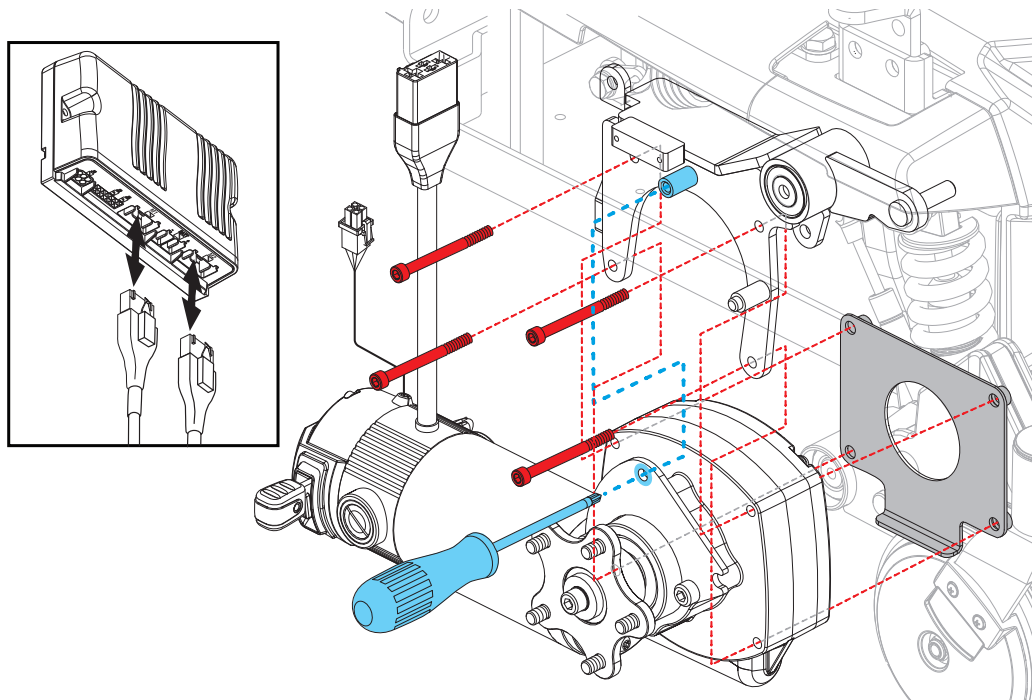

Figure 2. Installing the Motor

To install the motor:

1. While holding the backing plate on the back of the motor, raise the motor assembly up into the motor mount weldment.
2. Insert screwdriver into the motor mount support slot. (Shown in blue.)
3. Reinstall the four screws of the motor mount and backing plate. Torque to 6ft – lbs. (Shown in red.) Then remove screwdriver once motor is secure.
4. Reroute the motor/brake harness to the power module and plug the connector into the power module.
5. Secure the harness with wire-ties.
6. Reinstall the drive wheel fender and replace the rear shroud.
7. Reinstall the drive wheel with its lug nuts.
8. Remove the power chair from the blocks.
9. Test all power chair systems.

